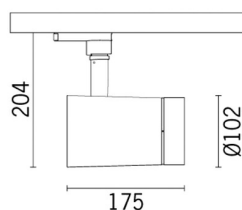

Last information update: May 2024

Product configuration: N208

N208: small body - warm white - ssp 6° optic

**Product code**N208: small body - warm white - ssp 6° optic **Attention! Code no longer in production****Technical description**

Adjustable spotlight with adapter for installation on a mains voltage track. Luminaire made of die-cast aluminium. Spotlight double adjustability allows a 360° rotation about the vertical axis and 90° tilting relative to the horizontal plane. Mechanical aiming locks both for rotation about the vertical axis and tilting relative to the horizontal plane. Optical assembly made up of 2 LED lamps in a warm white tone 3000K CRI90, and single chip technology, to obtain a super spot cone of light. Electronic ballast integrated in the cylinder.

Installation

On an electrified track or base

Colour

White (01) | Black (04)

Weight (Kg)

1.47

Mounting

three circuit track

Wiring

Product complete with electronic components

Complies with EN60598-1 and pertinent regulations

**Technical data**

Im system:	284.4	CRI:	95
W system:	7.2	Colour temperature [K]:	3000
Im source:	360	MacAdam Step:	3
W source:	4.2	Life Time LED 1:	50,000h - L90 - B10 (Ta 25C)
Luminous efficiency (lm/W, real value):	39.5	Lamp code:	LED
Im in emergency mode:	-	Number of lamps for optical assembly:	1
Total light flux at or above an angle of 90° [Lm]:	0.0	ZVEI Code:	LED
Light Output Ratio (L.O.R.) [%]:	79	Number of optical assemblies:	1
Beam angle [°]:	6°	Control:	Completo di dimmer