

Last information update: January 2025

**Product configuration: PR97.01**

PR97.01: Dimmable electronic Ø102mm body - Super Spot optic - 13.8W 599.2lm - 3500K - CRI 90 - White

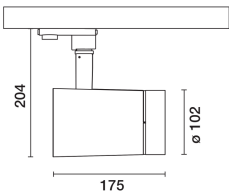

**Product code**

PR97.01: Dimmable electronic Ø102mm body - Super Spot optic - 13.8W 599.2lm - 3500K - CRI 90 - White

**Technical description**

Adjustable spotlight with adapter for installation on an electrified track or base. High chromatic yield LED lamp with 3500K tone and OptiBeam Lens optic system and Super Spot optic. Dimmable electronic power supply integrated in product with Tool Free manual dimmer. Luminaire made of die-cast aluminium and thermoplastic material that allows a 360° rotation about the vertical axis and 90° tilting relative to the horizontal plane with mechanical aiming locks. Passive heat dissipation. Spotlight with "Push&Go" system designed to hold up to two flat accessories at the same time. The same system can also be used to apply another external component selected from the directional flaps and anti-glare screen. All internal accessories rotate 360° about the spotlight longitudinal axis.

**Installation**

Installation on an electrified track or base.

**Colour**

White (01)

**Weight (Kg)**

1.33

**Mounting**

wall surface|ceiling surface

**Wiring**

Electronic components integrated in product

Complies with EN60598-1 and pertinent regulations



**Technical data**

lm system:	599	Life Time LED 1:	> 50,000h - L90 - B10 (Ta 25°C)
W system:	13.8	Lamp code:	LED
lm source:	1070	Number of lamps for optical assembly:	1
W source:	11	ZVEI Code:	LED
Luminous efficiency (lm/W, real value):	43.4	Number of optical assemblies:	1
lm in emergency mode:	-	Power factor:	See installation instructions
Total light flux at or above an angle of 90° [Lm]:	0	Inrush current:	5 A / 50 µs
Light Output Ratio (L.O.R.) [%]:	56	Maximum number of luminaires of this type per miniature circuit breaker:	B10A: 31 luminaires B16A: 50 luminaires C10A: 52 luminaires C16A: 85 luminaires
Beam angle [°]:	7.7°	Minimum dimming %:	1
CRI (minimum):	90	Overvoltage protection:	4kV Common mode & 2kV Differential mode
Colour temperature [K]:	3500	Control:	Completo di dimmer
MacAdam Step:	2		

**Polar**

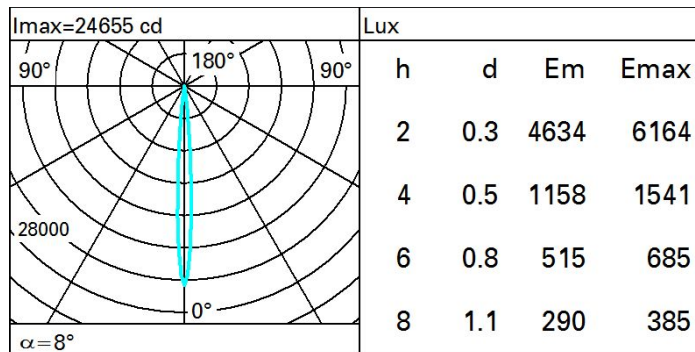

Utilisation factors

R	77	75	73	71	55	53	33	00	DRR
K0.8	50	48	46	44	47	46	45	43	78
1.0	53	50	48	47	50	48	48	46	82
1.5	55	53	52	51	53	52	51	49	88
2.0	57	56	55	54	55	54	53	52	93
2.5	58	57	56	56	56	56	55	53	95
3.0	59	58	57	57	57	57	56	55	97
4.0	59	59	59	58	58	58	57	55	99
5.0	60	59	59	59	59	58	57	56	100

Luminance curve limit

