

IMPORTANT - READ CAREFULLY BEFORE INSTALLING FIXTURE. RETAIN THESE INSTRUCTIONS FOR FUTURE REFERENCE.

THIS PRODUCT MUST BE INSTALLED IN ACCORDANCE WITH THE NATIONAL ELECTRICAL CODE AND ALL APPLICABLE LOCAL CODES, BY A PERSON FAMILIAR WITH THE CONSTRUCTION AND OPERATION OF THE PRODUCT, AND THE HAZARDS INVOLVED. PROPER GROUNDING IS REQUIRED FOR SAFETY.

⚠ DISCONNECT THE MAIN LINE BEFORE WIRING SECONDARY CONNECTORS.

NEW CONSTRUCTION PLASTER FRAME INSTALLATION (NC) - REMOTE DRIVER (REM)

A- ENGAGE (4) HANGER BARS IN HOUSING SLOTS AVAILABLE AND CONNECT THEM TOGETHER.

B- FASTEN HANGER BARS TO CEILING BRACE WITH #8 SCREWS (**NOT INCLUDED**). PLASTER FRAME MUST BE FLUSH WITH CEILING BRACE AND INSURE SMALL FOLDED TAB IS PLACED UNDER CEILING BRACE.

C- INSTALL DRYWALL AND MAKE THE CUT-OUT OPENING (**SEE DIMENSIONS BELOW**). LEAVE AT LEAST 6" (152mm) OF FEEDER CABLE ACCESSIBLE FROM UNDER THE CEILING.

FLUSH MOUNTED MODEL:

C- INSTALL DRYWALL AND MAKE THE CUT-OUT OPENING (**SEE DIMENSIONS BELOW**).

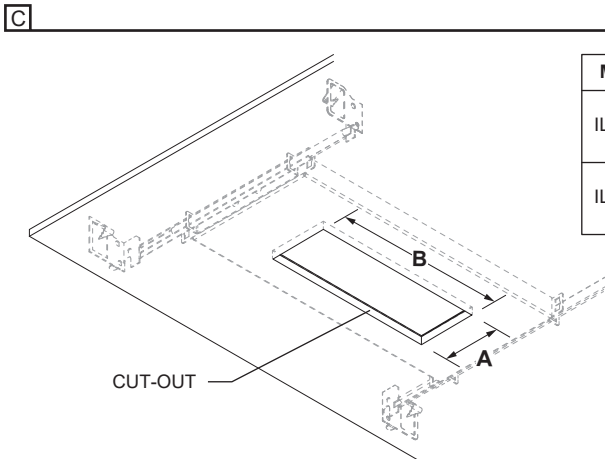
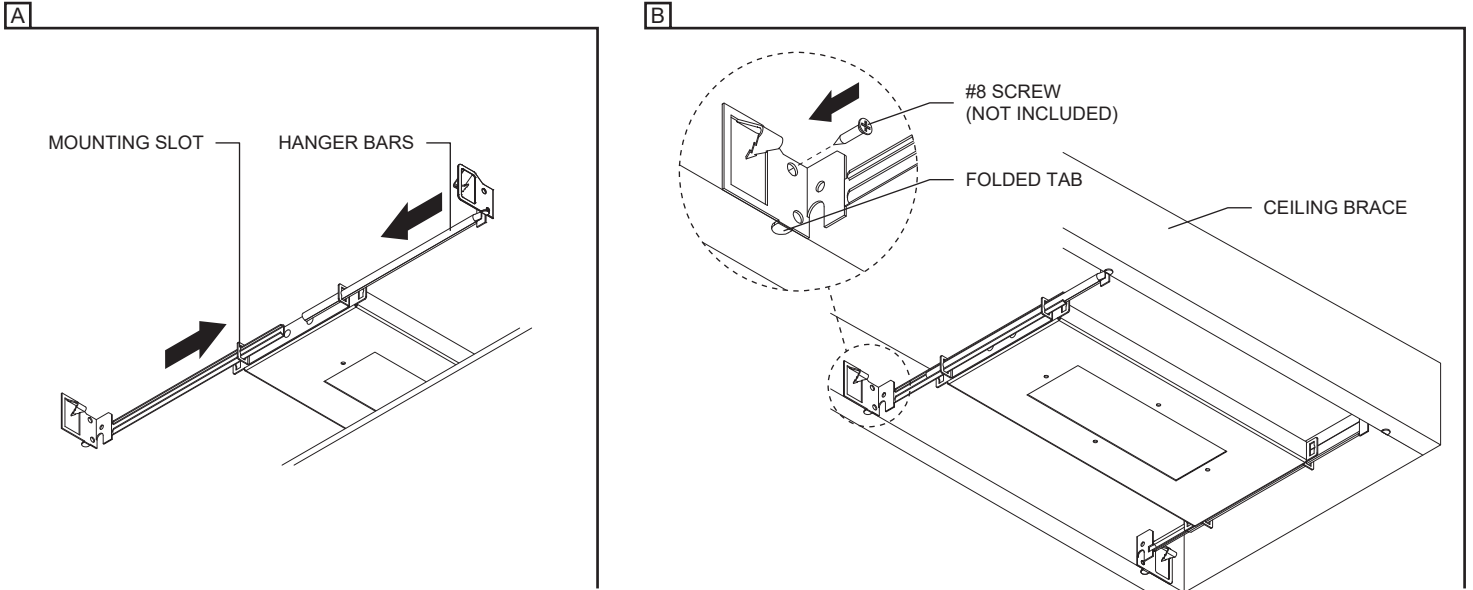

Model	Plaster frame	Cut-out dimensions (A x B)	Ceiling thickness	Clearance
ILBIO02	BN-LBIO02-TR-NC	1 $\frac{3}{8}$ " x 2 $\frac{1}{2}$ " (35 x 64mm)	$\frac{1}{8}$ "-1 $\frac{1}{8}$ " (3-29mm)	3 $\frac{3}{4}$ " (83mm)
	BN-LBIO02-FM-NC	2 $\frac{3}{16}$ " x 3 $\frac{1}{2}$ " (55 x 88mm)	$\frac{9}{16}$ " (16mm)	
ILBIO05	BN-LBIO05-TR-NC	1 $\frac{1}{2}$ " x 5 $\frac{5}{16}$ " (37 x 141mm)	$\frac{1}{8}$ "-1 $\frac{1}{8}$ " (3-29mm)	
	BN-LBIO05-FM-NC	2 $\frac{3}{16}$ " x 6 $\frac{1}{2}$ " (55 x 165mm)	$\frac{9}{16}$ " (16mm)	

FLUSH MOUNTED INSTALLATION ASSEMBLY FINISH

A- FINISH THE ASSEMBLY BY PLASTERING, SANDING AND PAINTING.

A

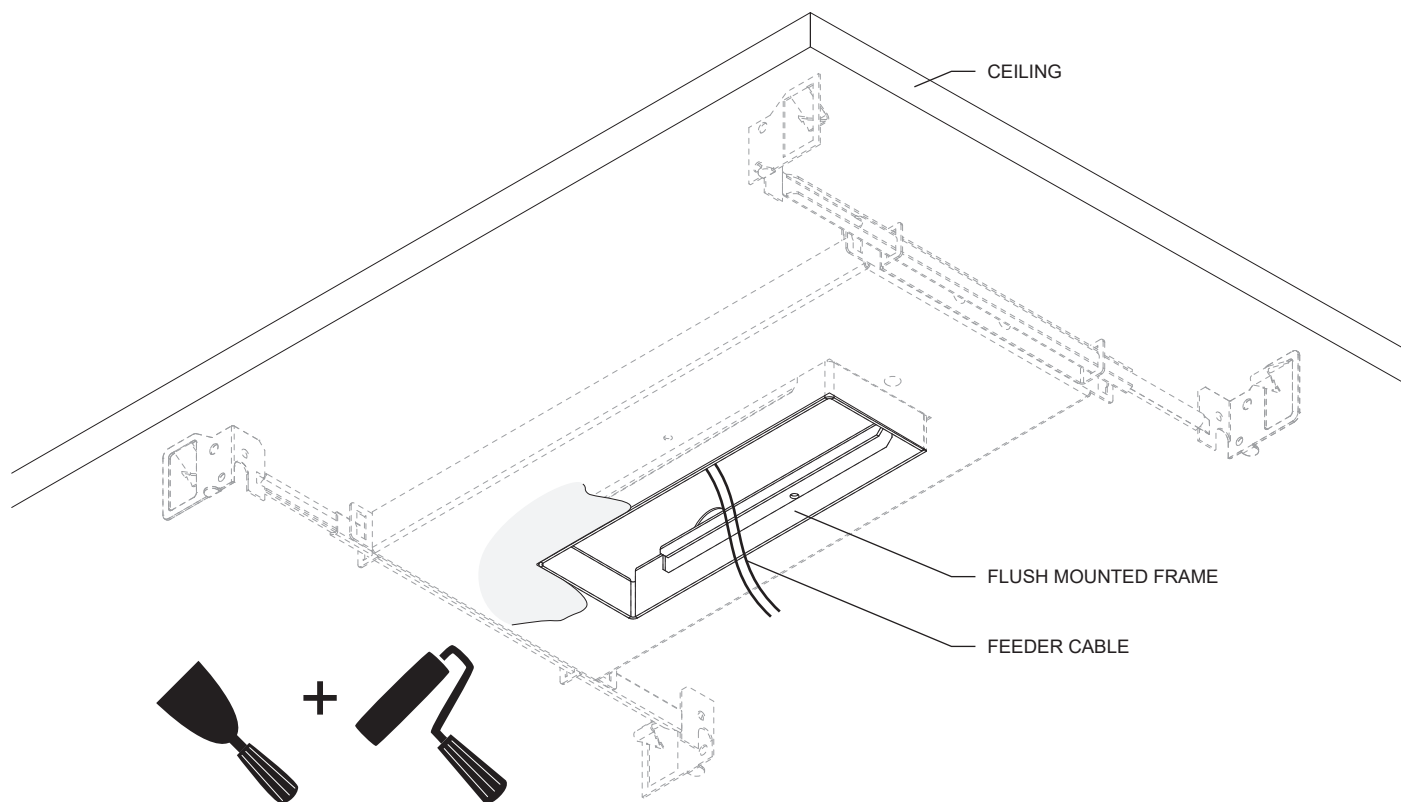

FIXTURE INSTALLATION

- A- MAKE ALL NECESSARY CONNECTIONS (**FOLLOWING WIRING DIAGRAM AND POLARITY MARKING**) USING THE CONNECTORS (**INCLUDED**).
 B- HOLD THE (2) CLIPS UPWARD AND INSERT FIXTURE INTO CUT-OUT.

FLUSH MOUNTED MODEL:

- B- HOLD THE (2) CLIPS UPWARD AND INSERT FIXTURE INTO CUT-OUT. ONCE INSERTED INTO THE FRAME, THE CLIPS SPRING BACK DOWN AND THE FRAME HOOKS WILL HOLD THE FIXTURE IN PLACE.

A + B

WIRING DIAGRAM

Multiple luminaires must be connected in series
 (home run or fixture chain)

