



WARNING:

THE SAFETY OF THIS FIXTURE IS GUARANTEED ONLY IF YOU COMPLY WITH THESE INSTRUCTIONS; REMEMBER TO CONSERVE IN A SAFE PLACE.

ATTENTION:

LA SÉCURITÉ DE L'APPAREIL N'EST GARANTIE QU'EN CAS D'UTILISATION CORRECTE DES INSTRUCTIONS SUIVANTES; IL FAUT PAR CONSÉQUENT LES CONSERVER.

ATTENCION:

LA SEGURIDAD DEL APARATO SE GARANTIZA SOLO CUMPLIENDO CUIDADOSAMENTE LAS SIGUIENTES INSTRUCCIONES; ES NECESARIO CONSERVARLAS.

ATTENZIONE:

LA SICUREZZA DELL'APPARECCHIO E' GARANTITA SOLO CON L'USO APPROPRIATO DELLE SEGUENTI ISTRUZIONI; PERTANTO E' NECESSARIO CONSERVARE.

EN Install in accordance with National electric code, local and federal code specification.

FR Installer ce produit en conformité avec le code électrique national et les spécifications du code local et fédéral.

ES Instalar el producto respetando las normas eléctricas nacionales y las especificaciones de las normas locales y federales.

IT Si prega di installare questo conformità con il national electrical code e le specifiche del codice locale e federale.

EN N.B.: WHEN INSTALLING THE SYSTEM, STRICTLY COMPLY WITH ALL REGULATIONS ON INSTALLATION IN FORCE.

FR N.B.: LORS DE L'INSTALLATION DU SYSTÈME VEILLER RESPECTER RIGOREUSEMENT LES NORMES EN VIGUEUR EN LA MATIÈRE.

ES N.B.: DURANTE LA INSTALACIÓN DEL SISTEMA RESPECTAR E SCRUPULOSAMENTE LAS NORMAS DE INSTALACIÓN VIGENTES.

IT N.B.: DURANTE L'INSTALLAZIONE DEL SISTEMA RISPETTARE SCRUPOLOSAMENTE LE NORME IMPIANTISTICHE VIGENTI.

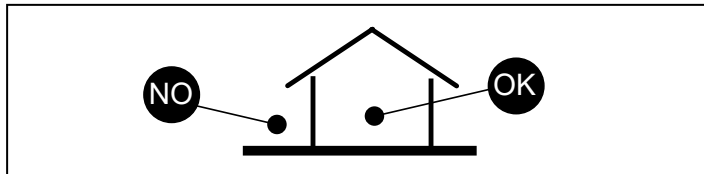
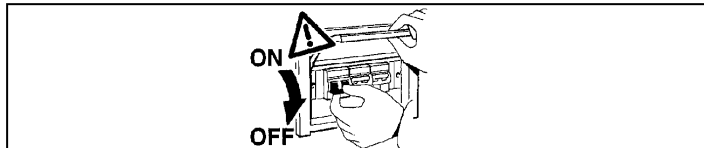

EN N.B.: For information on LED replacement please contact iGuzzini.

FR N.B.: Pour procéder au remplacement de la LED, adressez-vous à la société iGuzzini.

ES NOTA: Para sustituir el LED llame a la empresa iGuzzini.

IT N.B.: Per la sostituzione del LED contattare l'azienda iGuzzini.

EN Caution, risk of electric shock.

FR Attention, risque de chocs électriques.

ES Atención, riesgo de descarga eléctrica.

IT Attenzione, rischio di scossa elettrica.

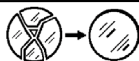

EN Should the lenses break, the product cannot be used. Contact the manufacturer for replacement.

FR En cas de bris des lentilles, le produit ne peut plus être utilisé. Contacter le fabricant pour procéder à son remplacement.

ES En caso de rotura de las lentes, el producto no puede utilizarse y se debe contactar con el fabricante para su sustitución.

IT In caso di rottura delle lenti il prodotto non può essere utilizzato, contattare il costruttore per la sua sostituzione.

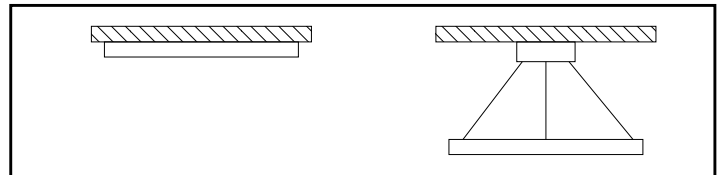

ART

PEOPLE	 Ø in Ø (mm)	Lb (kg)	DIRECT	DIRECT/ INDIRECT
	23 1/4" (590mm)	16.5lb (7.5kg)	I.ISL-S-S-DO-XXX-XX & I.ISL-S-CP-DI-XXX-XX	I.ISL-S-S-DO-XXX-XX & I.ISL-S-CP-DI-XXX-XX
	34 1/4" (870mm)	31lb (14,1kg)	I.ISL-M-S-DO-XXX-XX & I.ISL-M-CP-DI-XXX-XX	I.ISL-M-S-DO-XXX-XX & I.ISL-M-CP-DI-XXX-XX
	45 1/4" (1150mm)	52lb (23,7kg)	I.ISL-L-S-DO-XXX-XX & I.ISL-L-CP-DI-XXX-XX	I.ISL-L-S-DO-XXX-XX & I.ISL-L-CP-DI-XXX-XX

SURFACE INSTALLATION

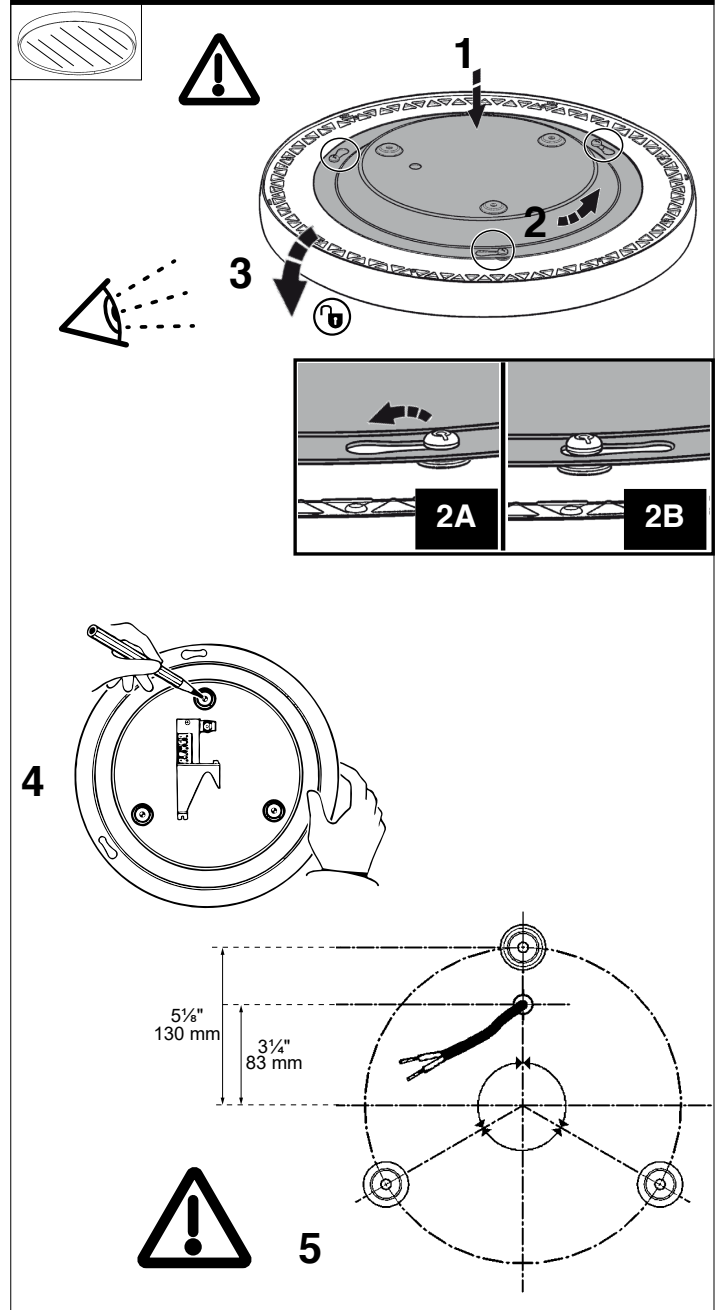

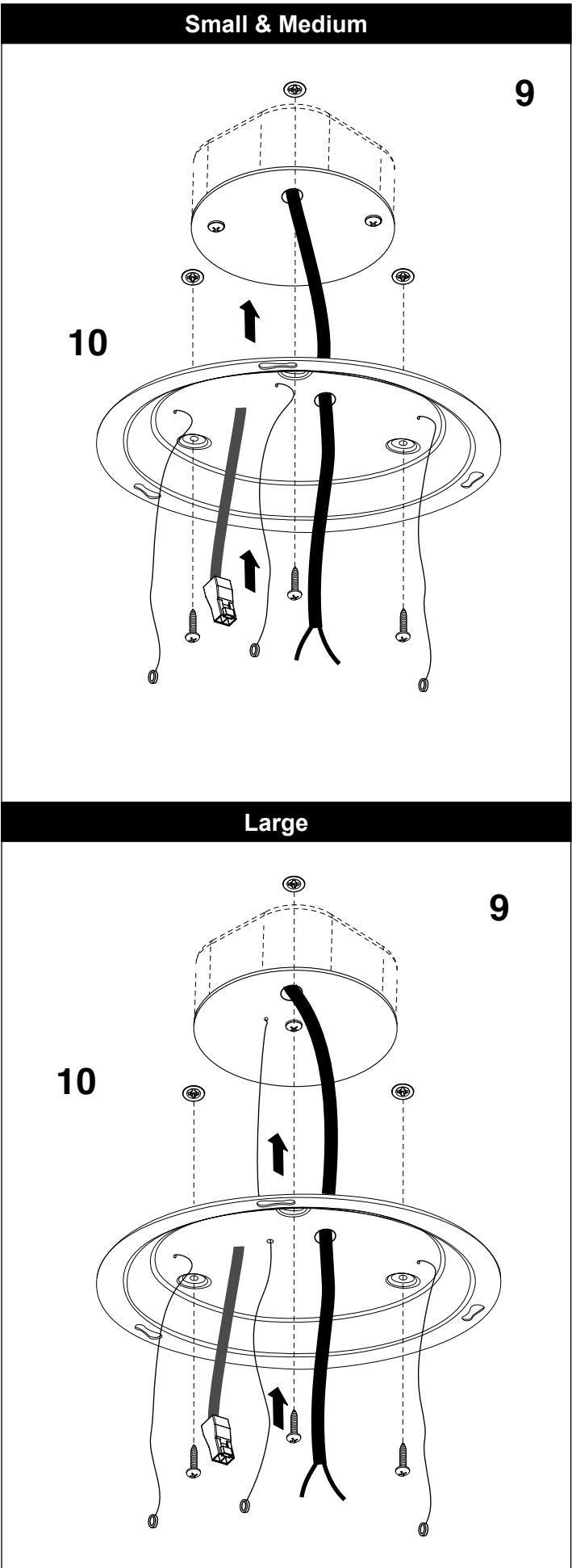
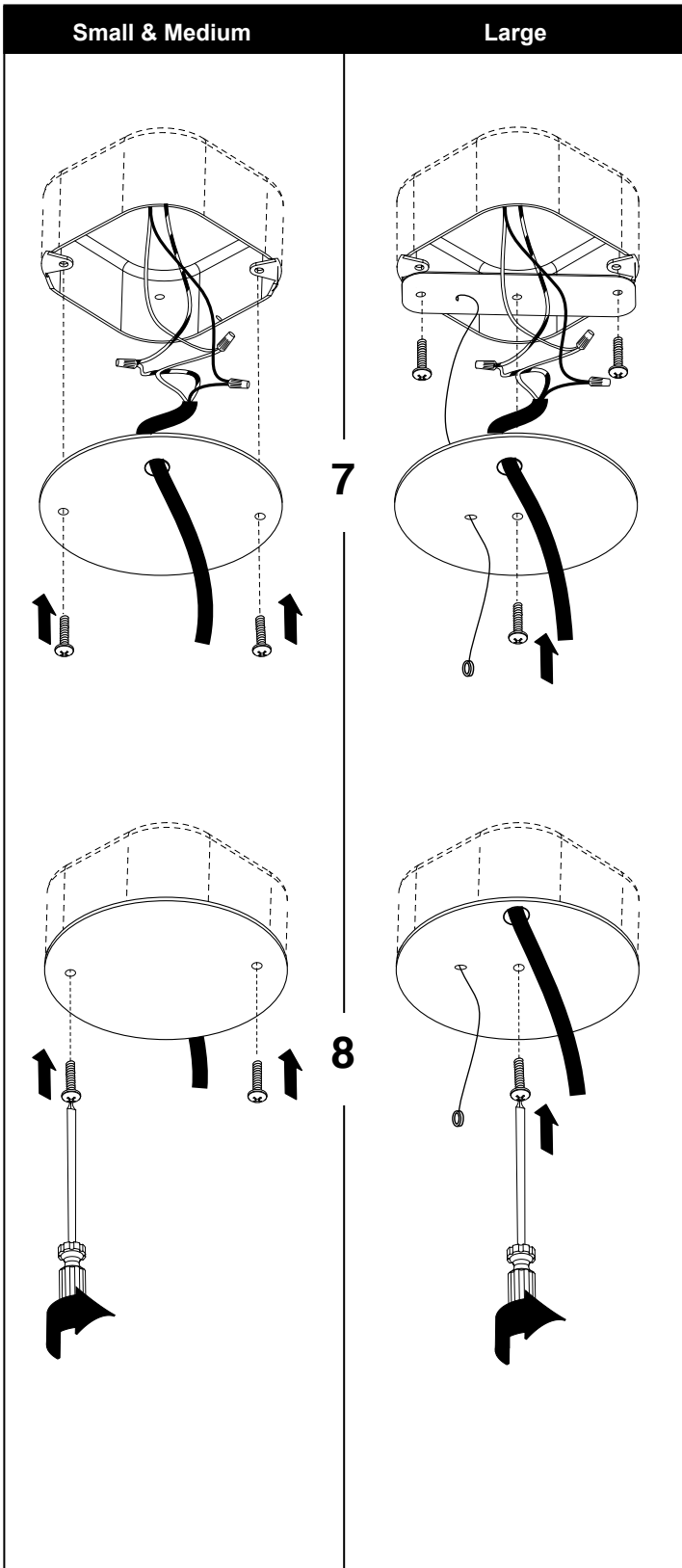
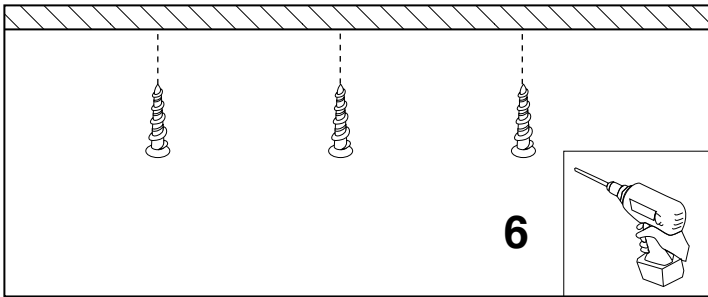

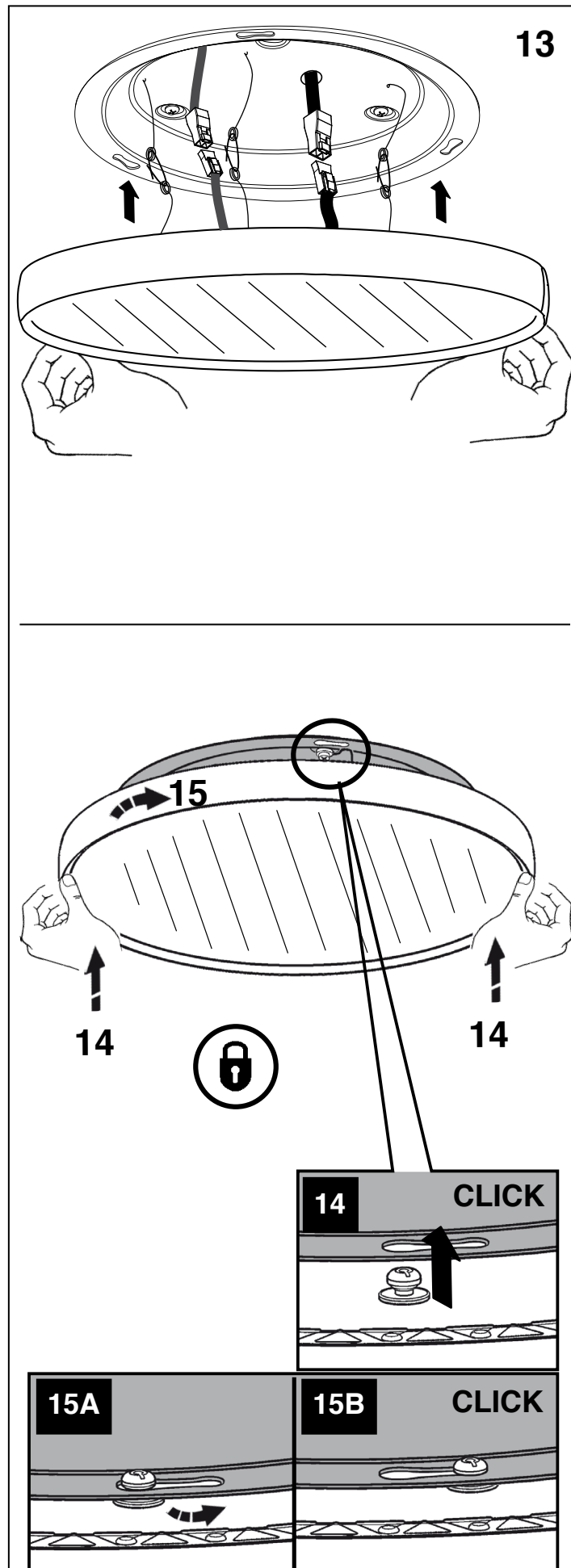
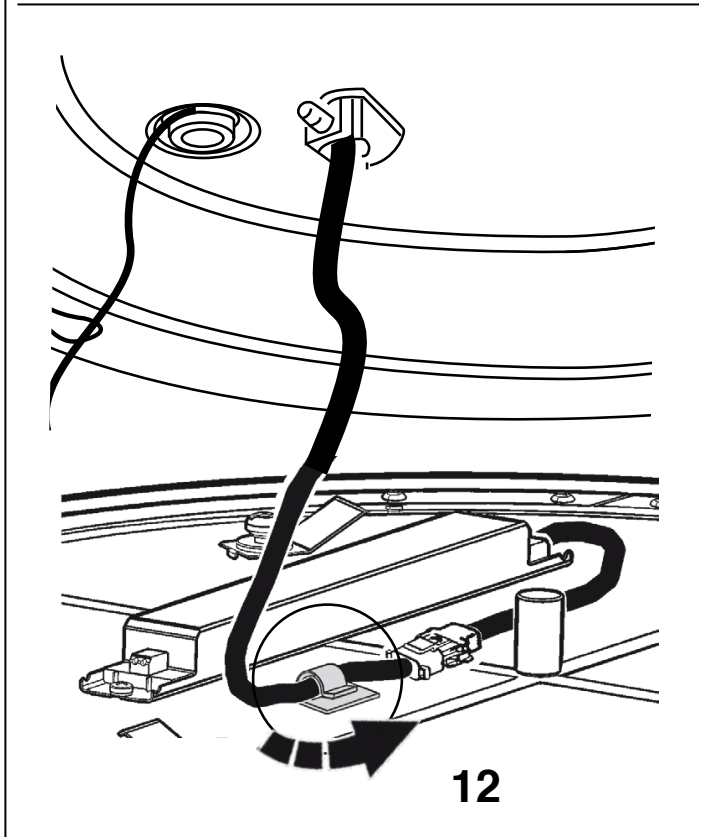
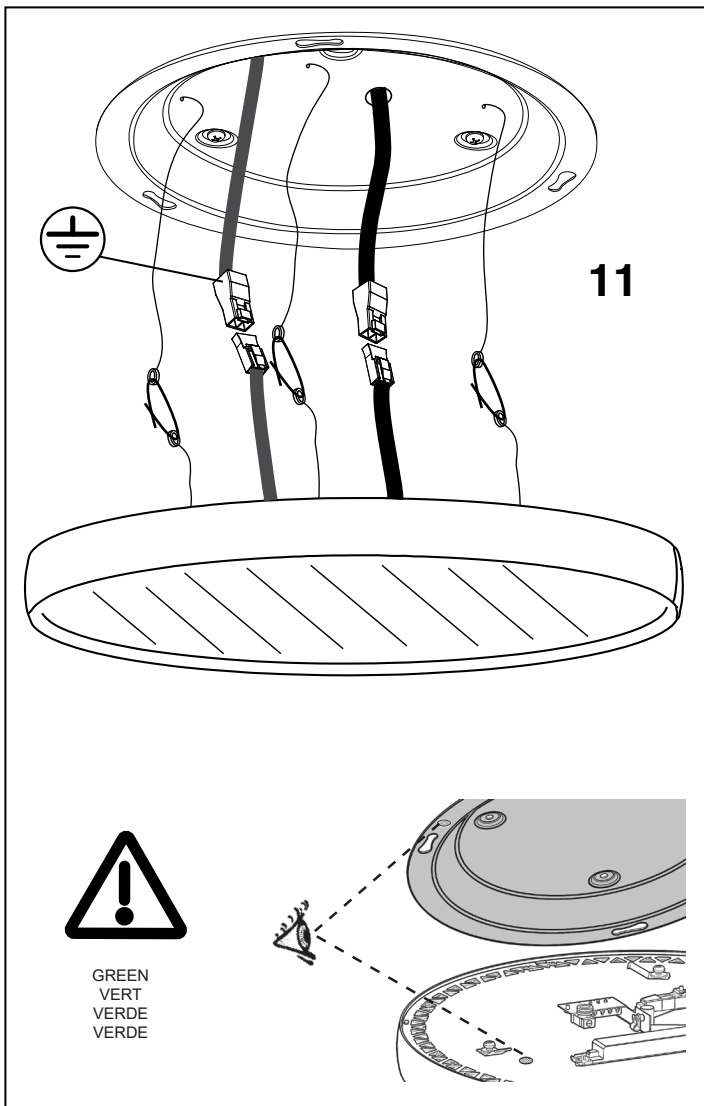

PENDANT INSTALLATION

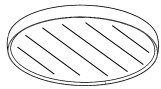
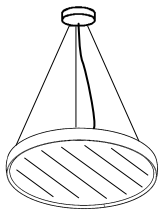

+

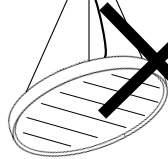
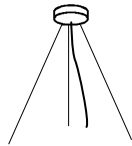

NO



NO

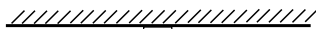
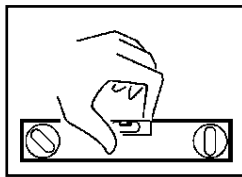

OK

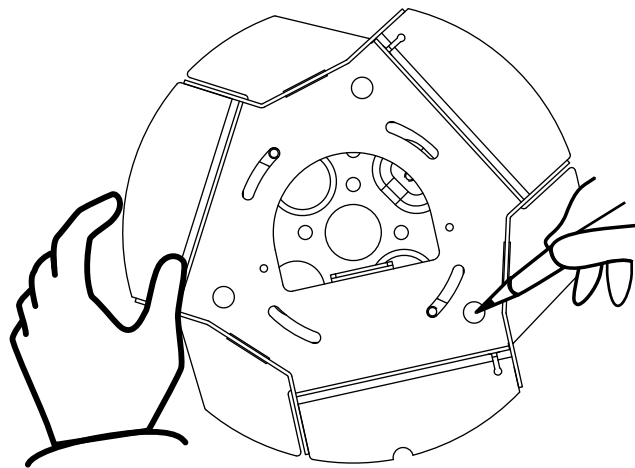
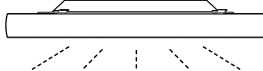

2



4

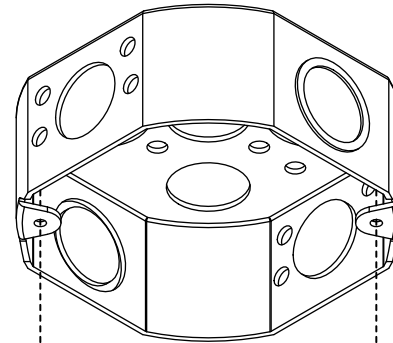

3

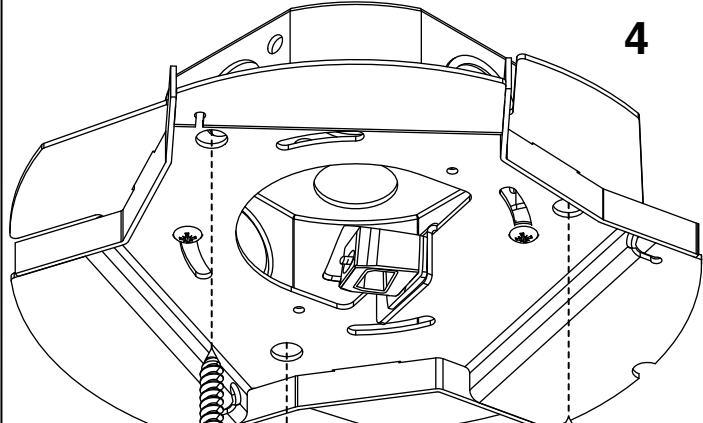
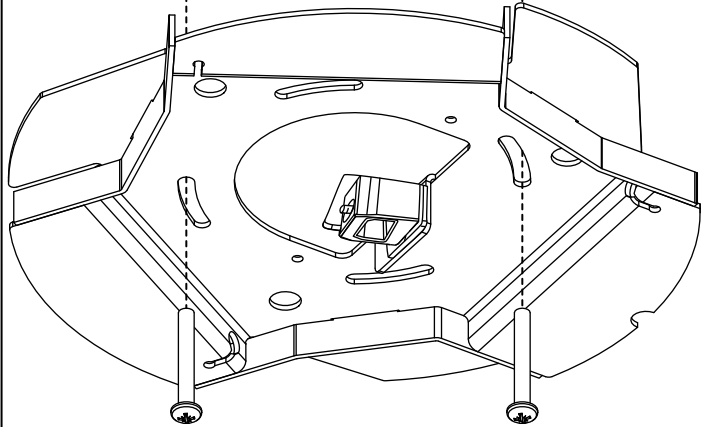

4

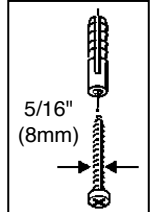
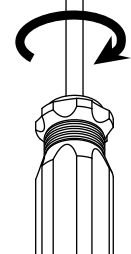
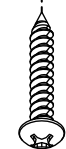

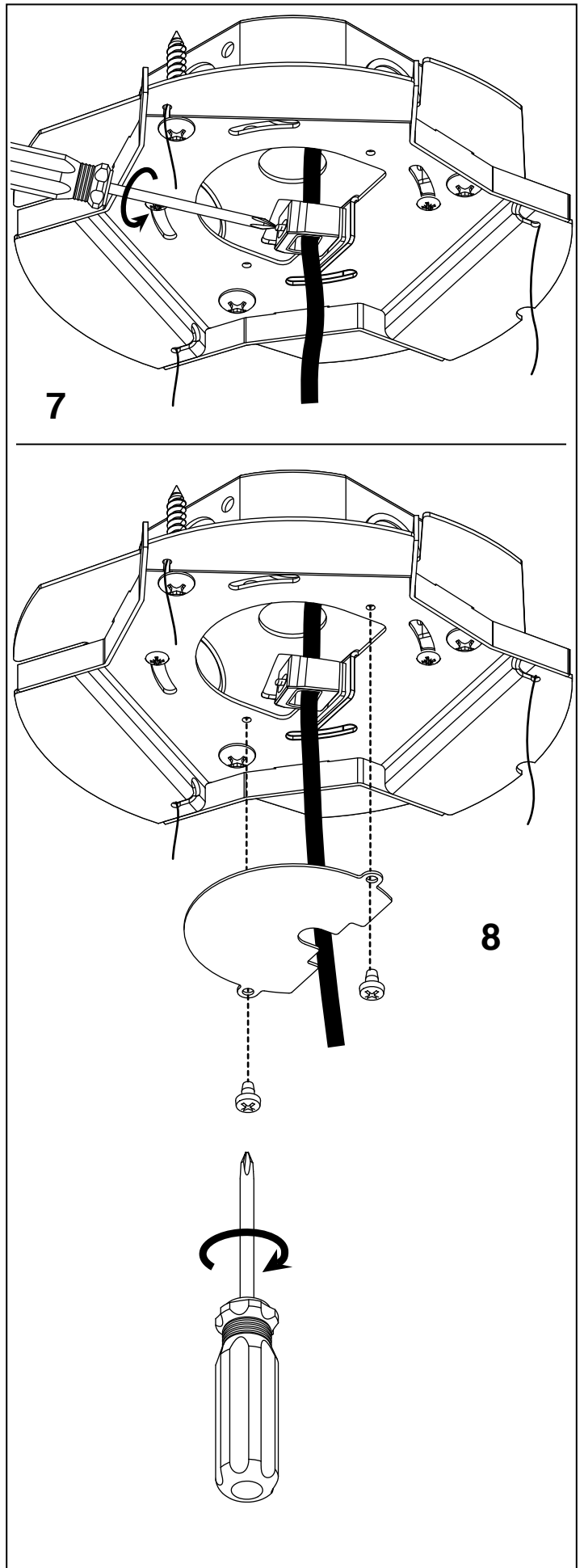
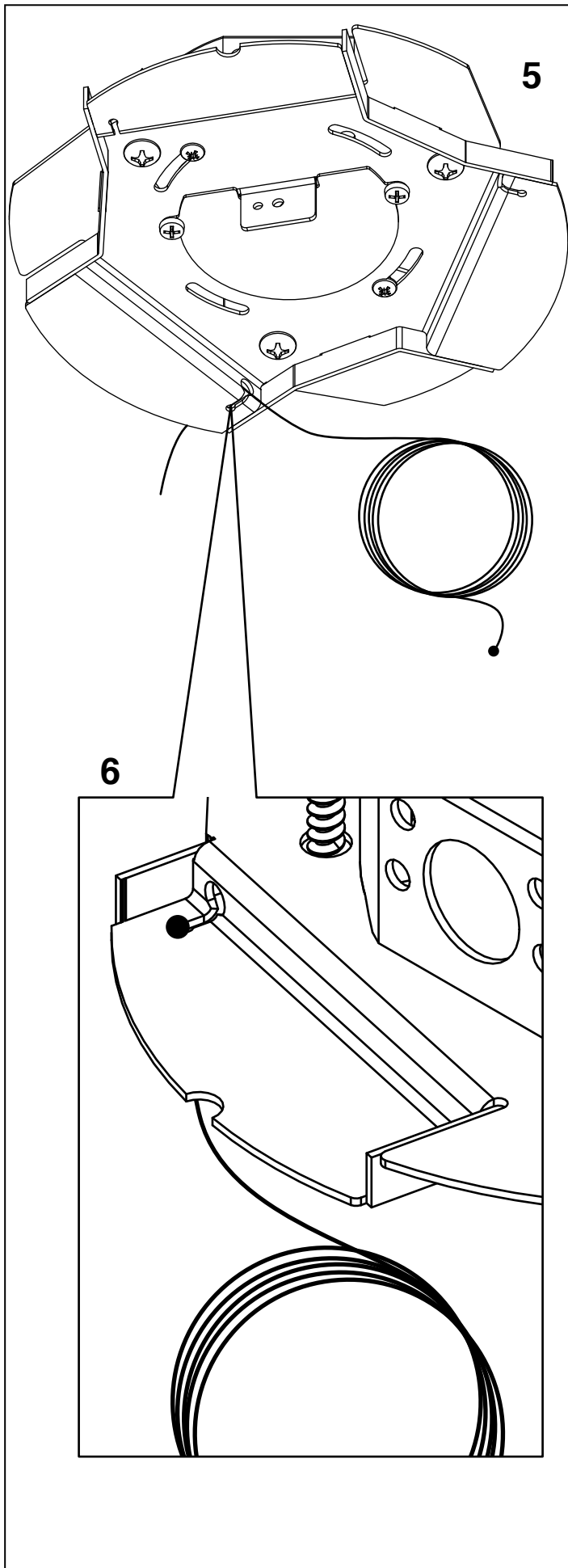

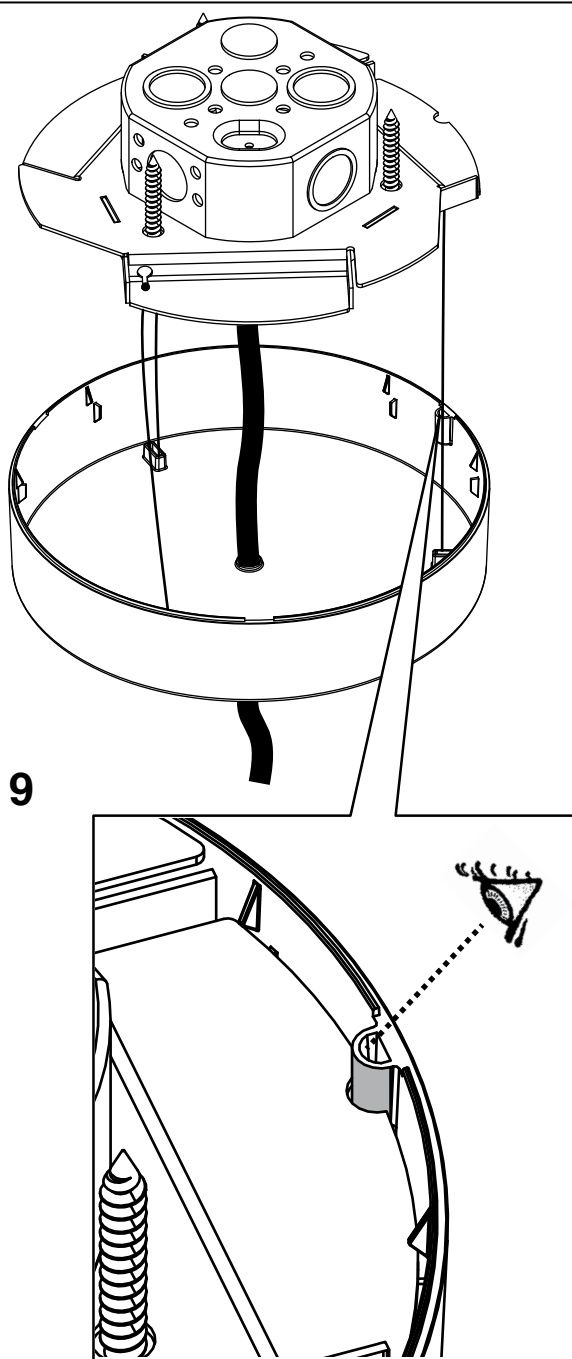

9

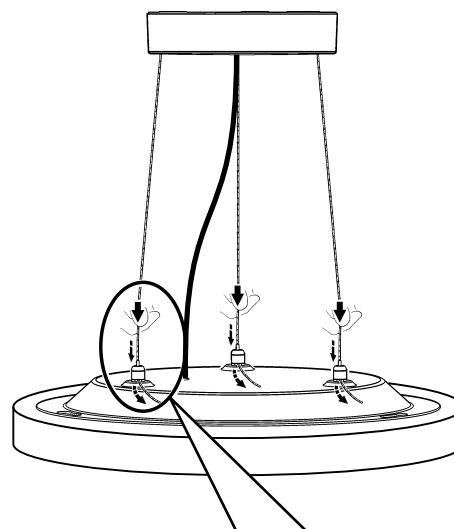

10

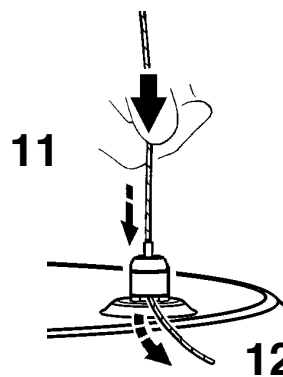

11

12

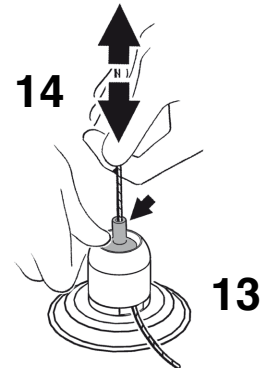

14

13

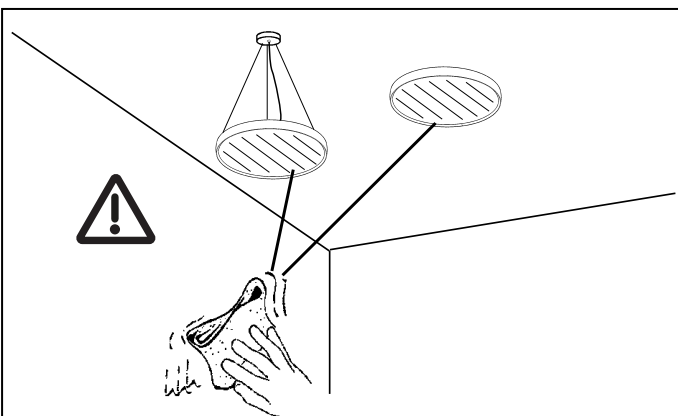

EN For ordinary cleaning we suggest to use water or no-abrasive water-based neutral detergents. Do not use abrasive cloths or tools to remove dirt..

FR Pour le nettoyage normal, il est conseillé d'utiliser de l'eau ou des détergents neutres à base aqueuse non abrasives. Éviter d'utiliser des chiffons ou outils abrasifs pour éliminer la saleté.

ES Para la limpieza ordinaria se recomienda utilizar agua o una solución de detergente neutro no abrasivo con agua. No utilizar paños ni herramientas abrasivas para eliminar la suciedad.

IT Per la pulizia consigliamo di utilizzare acqua o detersivi neutri a base acquosa non abrasivi. Non utilizzare panni o strumenti abrasivi per eliminare lo sporco.

iGuzzini North America

9320 Boul. St-Laurent
suite 100, vMontréal (Québec)
Canada H2N 1N7
P.: 514.523.1337
F.: 514.525.6107
www.iguzzini.com/us
CL - 02.03.2021

Headquarters iGuzzini illuminazione spa
via Mariano Guzzini, 37 - 62019 Recanati Italy