



Collection of specification grade architectural downlights for commercial and institutional application. The professional optics deliver uniform light cones with low luminance and sharp cut off. The Laser Blade Large Adjustable is available with trim or trimless design and Spot, Medium, Flood or Wide Flood distribution.

## Luminaire characteristics:

**Power input:** 7.5W or 12W  
**Lumens:** 325 to 730lm (3000K, 90CRI)  
**Luminaire efficacy:** Up to 72 lm/W

<b>Source:</b>	White LED (LM-80 tested) 2700K : 90CRI, 3000K : 90CRI, 3500K : 90CRI, 80CRI, 4000K : 80CRI.
<b>Lumen maintenance:</b>	80% of initial lumens at 50 000 hours (L80) (LM79 tested).
<b>Optics:</b>	Spot, Medium, Flood or Wide Flood with Optibeam technology. 355° internal rotation and max 30° tilt
<b>Material:</b>	Body and heat sink: Die-cast aluminum, Reflector and Baffle: Metalized thermoplastic, Diffuser: Protection glass, Hardware: Steel springs, connection box: Galvanized steel.
<b>Mounting:</b>	New construction housing suitable for open ceiling, insulated ceiling and Chicago plenum rating. See page 4 for details.
<b>Electrical:</b>	Integral high efficiency power supply rated at 50 000 hours, 120V or 277V.
<b>Dimming:</b>	0-10V dimming (120 / 277V). (down to 15%).
<b>Finish:</b>	See page 5 for details.
<b>Weight:</b>	1.28lb (0.58kg).
<b>Warranty:</b>	5 year limited warranty.
<b>Ratings:</b>	IP20, IP23 (from under the ceiling)
<b>Certification:</b>	 cULus listed for damp location. Interior use only.

## ACCESSORIES

(TO BE ORDERED SEPARATELY)

☐ **I.MY40-24** - Reflector for elliptical distribution



☐ **I.MY39-02** - Honeycomb anti-glare (black)



☐ **I.MW78-24** - Diffuser glass (Clear transparent)



☐ **I.MW78-65** - Diffuser glass (Nitric)

☐ **I.MY42-24** - Soft lens filter (Clear transparent)



☐ **I.MW14-05** - Coloured filter (Red)

☐ **I.MW14-06** - Coloured filter (Yellow)

☐ **I.MW14-16** - Coloured filter (Blue)



## ORDERING INFO

**ILBL1** - - - - -  
FIXTURE

**BI-LBLADJ1** - **UNV** - **D10**  
HOUSING

### MODEL

☒ **L1** - Single

### MOUNTING

☐ **TR** - Trim

☐ **TL** - Trimless

### INSTALLATION TYPE

☐ **IC** - Insulated ceiling

☐ **CP** - Chicago plenum

### LED

☐ **927** - 2700K, 90CRI

☐ **930** - 3000K, 90CRI

☐ **935** - 3500K, 90CRI

☐ **835** - 3500K, 80CRI<sup>(1)</sup>

☐ **840** - 4000K, 80CRI<sup>(2)</sup>

### OPTIC

☐ **ASP** - Adjustable, Spot

☐ **AMD** - Adjustable, Medium

☐ **AFL** - Adjustable, Flood

☐ **AWF** - Adjustable, Wide flood

### FINISH

(Trim finish / Baffle finish)

☒ **Black baffle**

**White Trim**

☐ **01** - White/Black

**Gray Trim**

☐ **10** - Gray/Black

**Black Trim**

☐ **02** - Black/Black

**Trimless**

☐ **02** - Black

☒ **White baffle**

☐ **31** - White/White

☐ **31** - White

<sup>(1)</sup> Available for adjustable spot (**ASP**) optic.

<sup>(2)</sup> Available for adjustable wide flood (**AWF**) optic.

DIMENSION

TRIM

LBL1

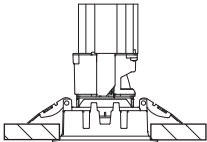

SIDE VIEW

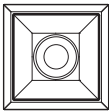

3 3/8"  
(86mm)

BOTTOM VIEW

TRIMLESS

LBL1

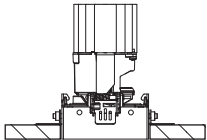

SIDE VIEW



2 7/8"  
(72mm)

BOTTOM VIEW

INSTALLATION OPTIONS

New construction with housing suitable for insulated ceiling (IC) or chicago plenum (CP)

Housing with hanger bars system for new construction installations. Suitable for open ceiling, insulated ceiling and Chicago Plenum applications. Housing and trim can be shipped separately.

Ceiling thickness:  
Trim: 1/8" to 1 1/8" (3mm - 29mm)  
Trimless: 3/8" to 1" (9mm - 25mm)  
Total weight: Max 9.18lbs (4.16kg)

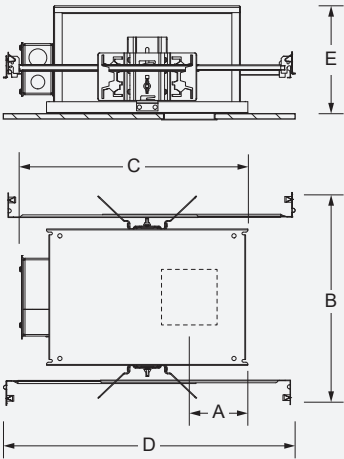

\*Provide a minimum of 1 1/8" (46mm) on each side for the hanger bar fixations

Model	Mounting	Housing	Cut-out dimensions	Cut-out position (A)	Overall dimensions (BxC)	Hanger bars (D)	Clearance (E)
LBL1	TRIM	BI-LBLADJ1TR-UNV-D10	2 7/8" x 2 7/8" (74 x 74mm)	3 1/2" (89mm)	12 3/4" x 14 3/8" (325mm x 366mm)	14 1/4" to 26" (362 to 660mm)	6 3/4" (171mm)
		BI-LBLADJ1TR-UNV-SP-D10					
		BI-LBLADJ1TR-UNV-CP-D10					
		BI-LBLADJ1TR-UNV-SP-CP-D10					
	TRIMLESS	BI-LBLADJ1TL-UNV-D10					
		BI-LBLADJ1TL-UNV-SP-D10					
		BI-LBLADJ1TL-UNV-CP-D10					
		BI-LBLADJ1TL-UNV-SP-CP-D10					

## PHOTOMETRIC DATA

Visit [iguzzini.com/us](http://iguzzini.com/us) for complete photometric data.

CCT (K)	CRI	LOAD (W)	OPTIC	LUMENS (lm)	EFFICACY (lm / W)	MAX CANDELA (cd)	MODELS
2700K	90	7.5W	Spot 11°	300	40	5 965	ILBL1-XX-927-ASP
		12W	Medium 24°	595	49	3 015	ILBL1-XX-927-AMD
			Flood 31°	665	55	2 390	ILBL1-XX-927-AFL
			Wide flood 50°	695	57	1 065	ILBL1-XX-927-AWF
3000K	90	7.5W	Spot 11°	325	43	6 445	ILBL1-XX-930-ASP
		12W	Medium 24°	625	52	3 165	ILBL1-XX-930-AMD
			Flood 31°	700	58	2 510	ILBL1-XX-930-AFL
			Wide flood 50°	730	60	1 115	ILBL1-XX-930-AWF
3500K	80	7.5W	Spot 11°	380	50	7 520	ILBL1-XX-835-ASP
	90	12W	Medium 24°	595	49	3 015	ILBL1-XX-935-AMD
			Flood 31°	665	55	2 390	ILBL1-XX-935-AFL
			Wide flood 50°	695	57	1 065	ILBL1-XX-935-AWF
4000K	80	12W	Wide flood 50°	870	72	1 330	ILBL1-XX-840-AWF

Spot 11° (3000K, 90CRI)

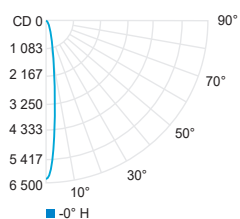

Medium 24° (3000K, 90CRI)

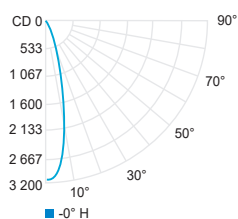

Flood 31° (3000K, 90CRI)

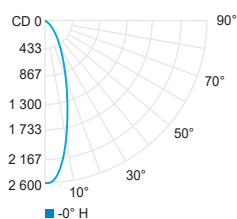

Wide flood 50° (3000K, 90CRI)

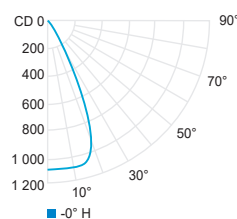

	Center beam fc	Beam width ft
2ft	1 612	0.4
4ft	403	0.7
6ft	179	1.1
8ft	101	1.5
10ft	64.5	1.9
12ft	44.8	2.2

	Center beam fc	Beam width ft
2ft	789	0.8
4ft	197	1.7
6ft	87.7	2.5
8ft	49.3	3.4
10ft	31.6	4.2
12ft	21.9	5.1

	Center beam fc	Beam width ft
2ft	628	1.1
4ft	157	2.2
6ft	69.8	3.3
8ft	39.3	4.4
10ft	25.1	5.5
12ft	17.5	6.6

	Center beam fc	Beam width ft
2ft	278	1.6
4ft	69.4	3.2
6ft	30.9	4.8
8ft	17.4	6.4
10ft	11.1	8.0
12ft	7.72	9.7