











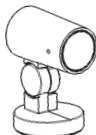



PALCO IN-OUT (accessories)





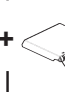

- IT Attenzione:**
La sicurezza dell'apparecchio e' garantita solo con l'uso appropriato delle seguenti istruzioni; pertanto e' necessario conservarle.
- EN Warning:**
The safety of this fixture is guaranteed only if you comply with these instructions; remember to conserve in a safe place.
- FR Attention:**
La sécurité de l'appareil n'est garantie qu'en cas d'utilisation correcte des instructions suivantes; il faut par conséquent les conserver.
- DE Achtung:**
Die sicherheit des gerätes wird nur durch sachgemässe befolgung nachstehender anweisungen gewährleistet; ihre aufbewahrung ist deshalb sehr wichtig.
- NL Opgelet:**
De veiligheid van dit toestel is slechts dan gegarandeerd als indien de volgende instructies strikt worden toegepast: daarom moet men ze ook bewaren.
- ES Atencion:**
La seguridad del aparato se garantiza solo cumpliendo cuidadosamente las siguientes instrucciones; por ello, es necesario conservarlas.
- DA Bemærk:**
Sikkerheden ved brug af armaturet kan kun garanteres, hvis disse anvisninger følges; sørg derfor for at gemme dem.
- NO Advarsel:**
Sikkerheten til dette apparatet garanteres kun hvis du overholder disse

- instruksjonene; husk å oppbevare dem på et trygt sted.
- sv Observera:**
Utrustningens säkerhet kan endast garanteras om dessa anvisningar respekteras i detalj. Spara därför dessa anvisningar för framtida konsultation.
- RU Внимание:**
Мы гарантируем безопасную эксплуатацию изделия только при соблюдении следующих инструкций; с этой целью необходимо сохранить данную брошюру.
- ZH 警告:**
为确保该装置安全, 请遵守操作指示; 并于安全场所放置。
- AR تحذير:**
لا يمكن ضمان سلامة هذا الجهاز إلا إذا التزمت بهذه التعليمات. يجب حفظها في مكان آمن.

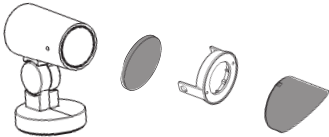

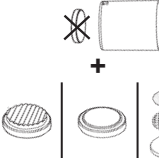
| | |  MAX 1 | | | |  MAX 1 | | | |  MAX 1 | | |
|-------------|------|--|---|---|---|--|---|---|---|--|---|---|
| | |  |  |  |  |  |  |  |  |  |  |  |
| ART Ø 83mm | X245 | X261 | X265 | X257 | X249 | X253 | X267 | ✗ | ✗ | ✗ | X541 | X535 |
| ART Ø 119mm | X246 | X262 | X266 | X258 | X250 | X254 | X268 | X275 | X320 | X269 | X542 | X536 |
| ART Ø 137mm | X302 | X310 | X312 | X308 | X304 | X306 | X314 | X318 | X321 | X316 | X543 | X537 |
| ART Ø 153mm | X303 | X311 | X313 | X309 | X305 | X307 | X315 | X319 | X322 | X317 | X544 | X538 |

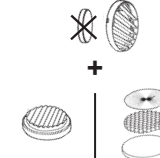
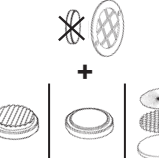
| | |  MAX 1 | | | | |
|-------------|--|---|---|---|---|---|
| | |  |  |  |  |  |
| ART Ø 83mm | | ✓ | ✓ | ✓ | ✗ | ✗ |
| ART Ø 119mm | | ✓ | ✓ | ✓ | ✓ | ✓ |
| ART Ø 137mm | | ✓ | ✓ | ✓ | ✓ | ✓ |
| ART Ø 153mm | | ✓ | ✓ | ✓ | ✓ | ✓ |

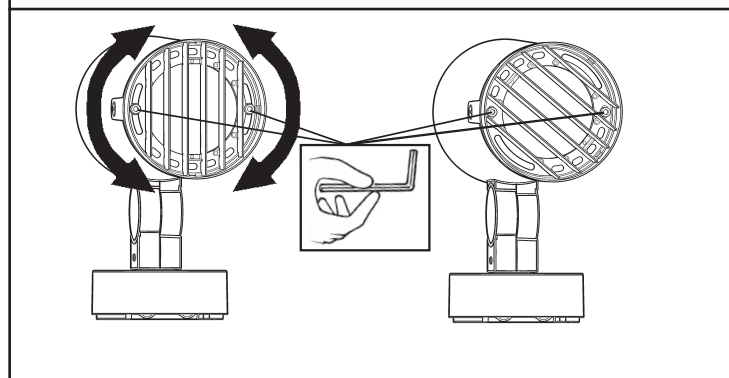
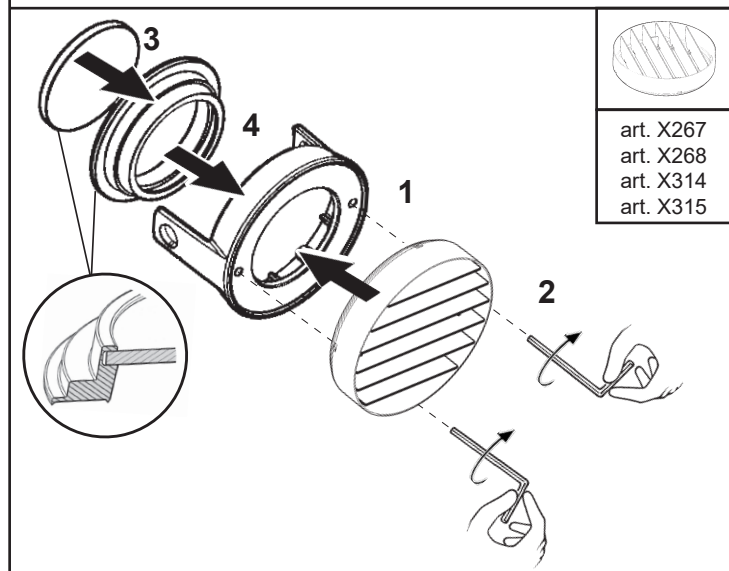
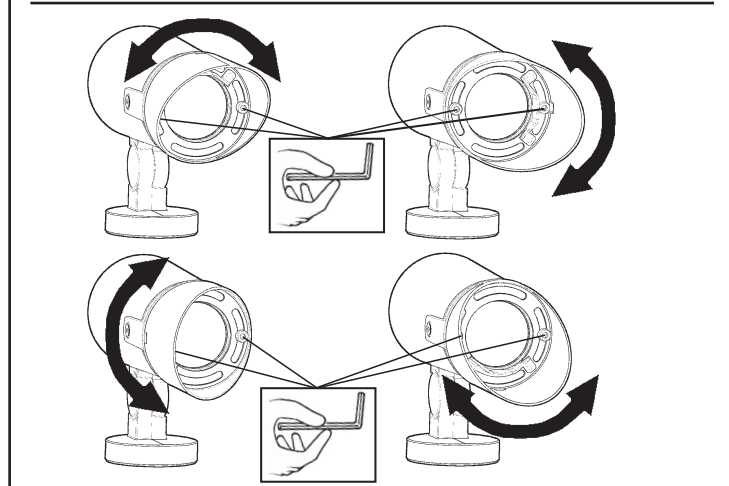
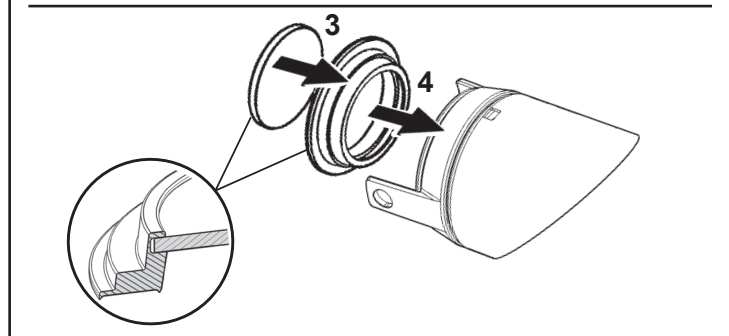
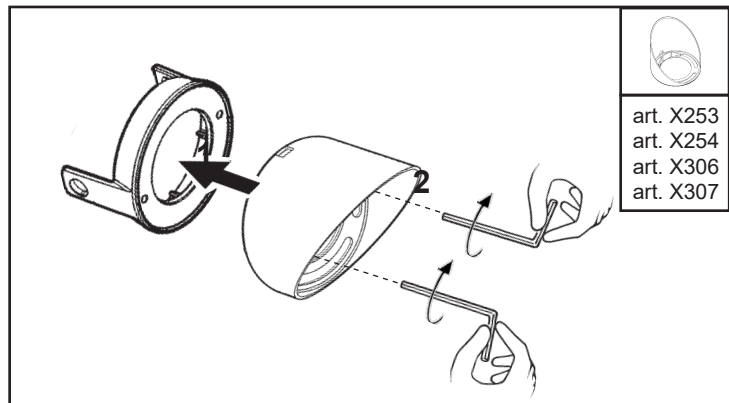
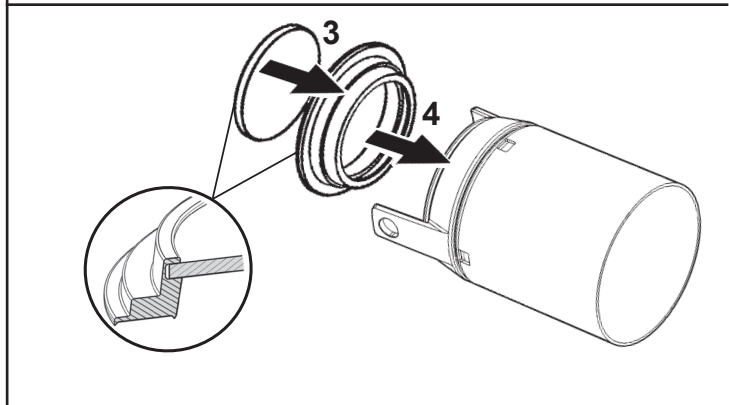
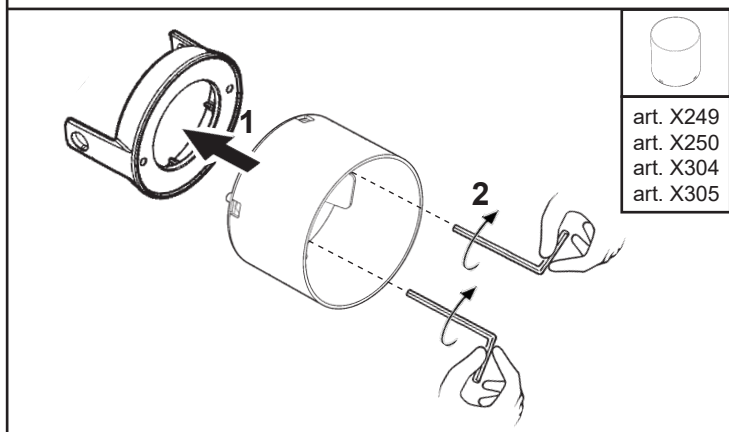
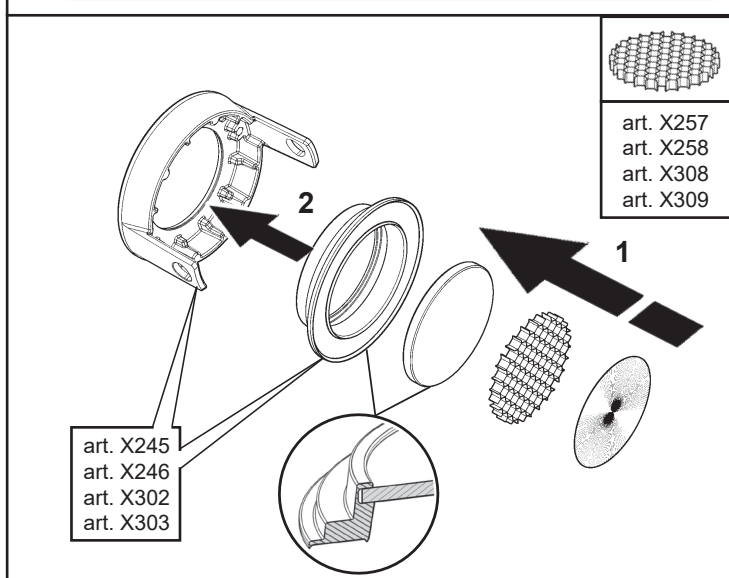
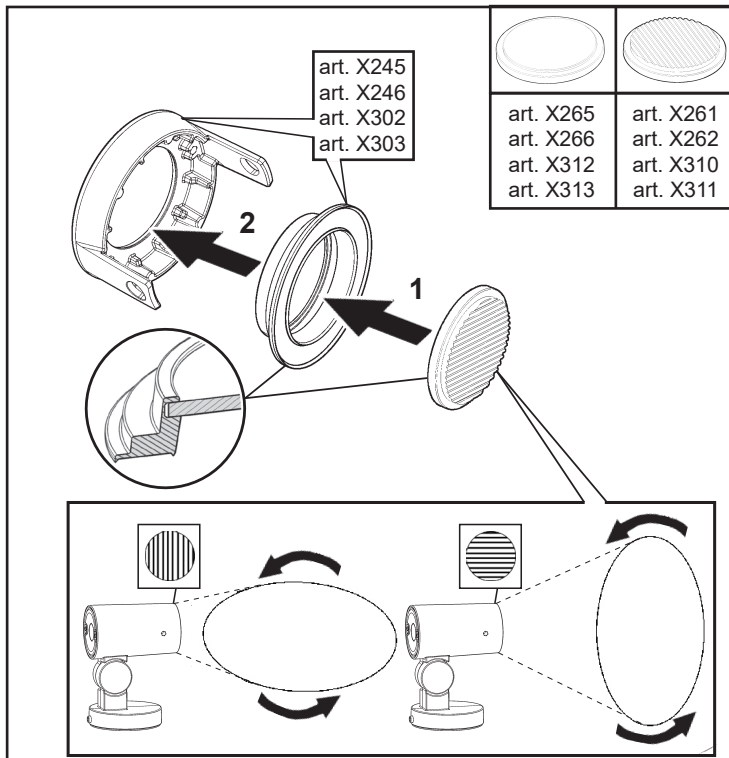





Serrare a fondo
Tighten firmly
Serrer à fond
Fest einrasten
Goed aanschroeven
Enroscar en firme
Skrues i bund
Trek til godt
Dra åt till botten
Закручивать до упора
ثبته بإحكام

Serrare a fondo
Tighten firmly
Serrer à fond
Fest einrasten
Goed aanschroeven
Enroscar en firme
Skrues i bund
Trek til godt
Dra åt till botten
Закручивать до упора
完全拧紧
ثبته بإحكام

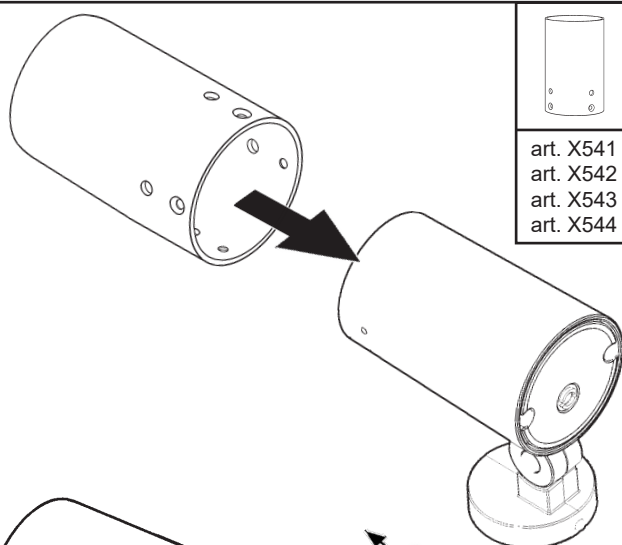

art. X541
art. X542
art. X543
art. X544

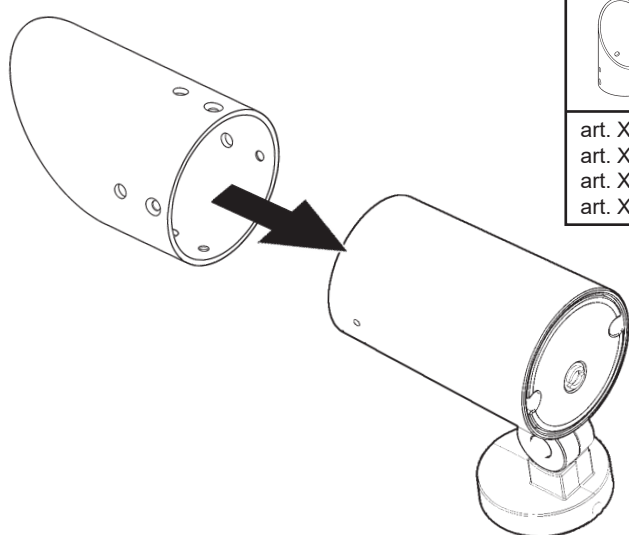
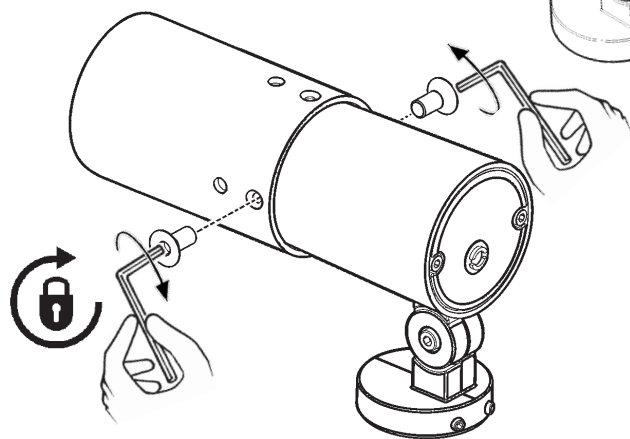

art. X535
art. X536
art. X537
art. X538

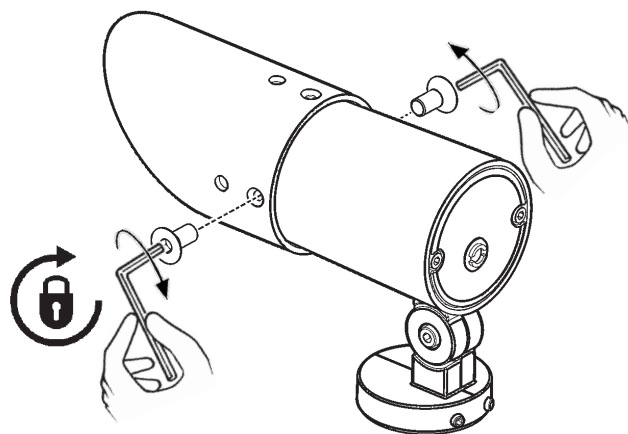

POSITION 1

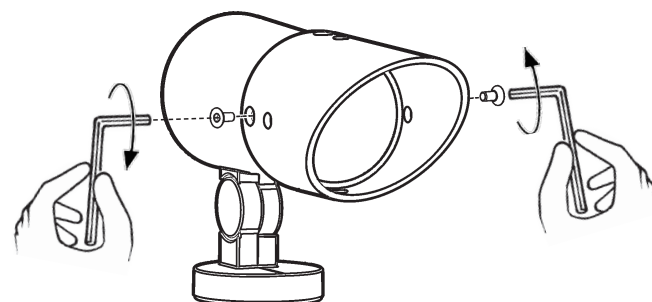

POSITION 2

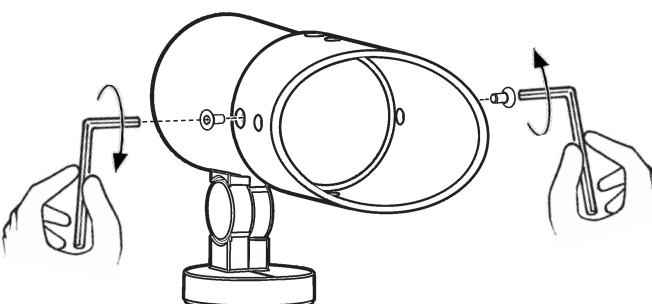

POSITION 3

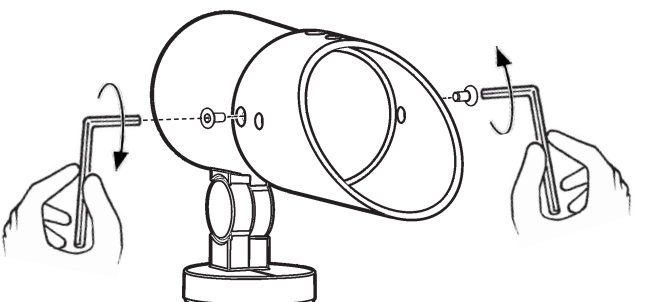

POSITION 4

