

Last information update: September 2024

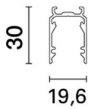
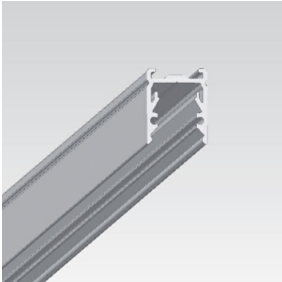

**Product code**

MXQ3: High surface linear profile for Ledstrip Top RGB versions - L=2000

**Technical description**

Rigid frameless aluminium profile for surface installation (high version); the shape of the profile allows application of all RGB Ledstrips with front emission LEDs, available in standard version (with adhesive) or tube version (with outer sheath). Finishes available: anodised grey - white. The profile may be completed with a diffuser screen available with two finishes: opal and translucent. The raised section of the profile, coupled with the opal diffuser screen, eliminates the pinpoint effect typical of strips.

**Installation**

surface-mounted; direct fixing with screws (not included); the profile has a longitudinal guide to facilitate drilling. For challenging installations, a kit of accessory clips is available (code MXM4 x 5 pcs); with preliminary fixing of the clips using screws, then profile snap-in anchoring on the clips prepared (screws not included). Accessory closing end caps (code MXQ6 - kit 2 x 5 pcs).

**Colour**

White (01) | Aluminium (12)

**Weight (Kg)**

0.67

**Mounting**

wall surface|ceiling surface

**Wiring**

Carefully read the Ledstrip instructions sheet

**Notes**

Carefully read the Ledstrip instructions sheet

Complies with EN60598-1 and pertinent regulations

850°C